

Joint OceanPredict Workshop and Kickoff of the Synergistic Observing Networks for Ocean and Earth System Predictions (SynObs)

15 – 18 November 2022

**Tsukuba Center for Institutions
(2F International Conference Hall)**

Observing System Evaluations Task Team (OS-Eval TT)
Coupled Prediction Task Team (CP-TT)



気象庁気象研究所
Meteorological Research Institute



OceanPredict
Advancing the science of ocean prediction



JAMSTEC 国立研究開発法人
海洋研究開発機構
Japan Agency for Marine-Earth Science and Technology

Venue map Restroom/Coffee

2_F

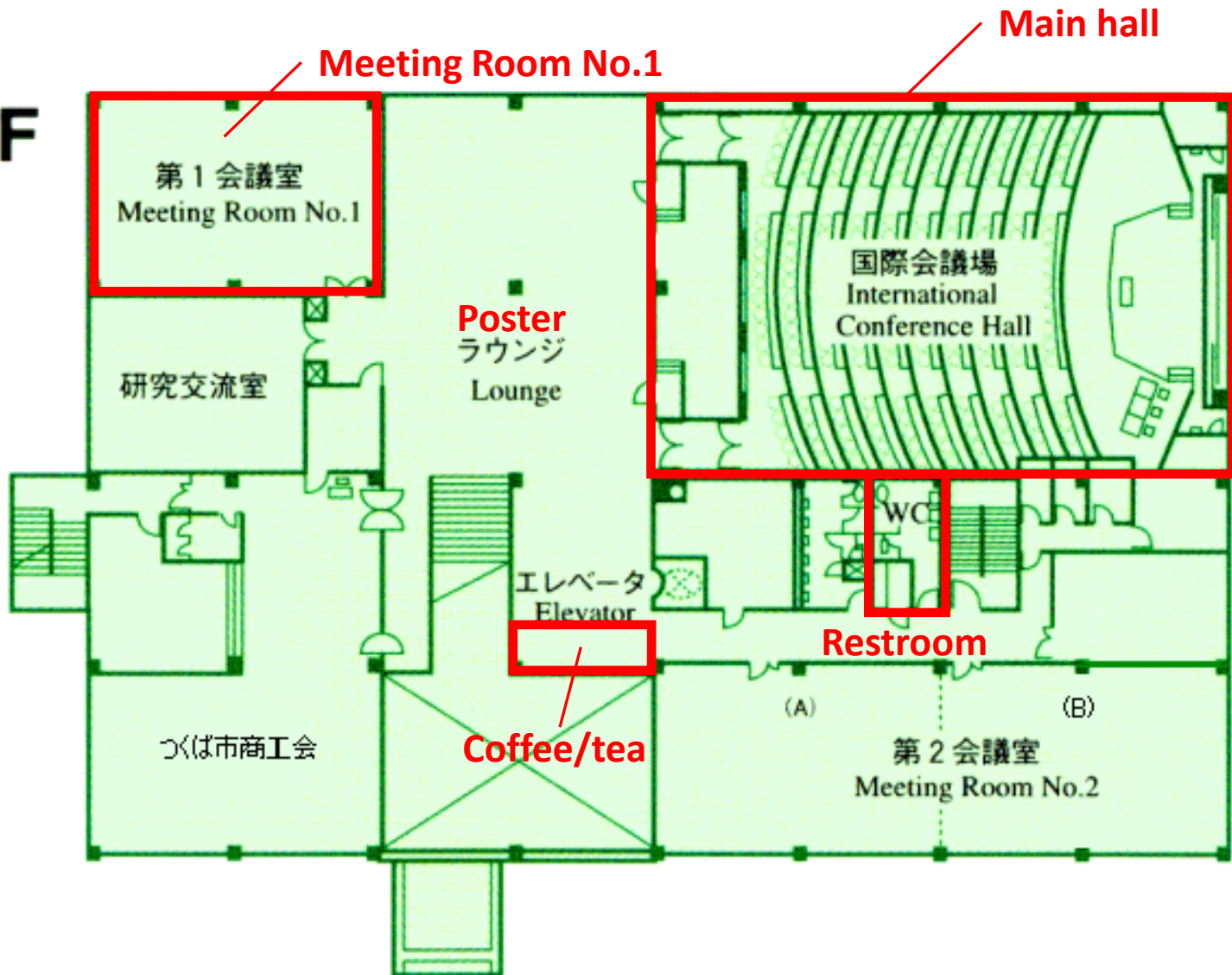

Emergency instruction



- In case of emergency, you will hear an alarm.
- Please evacuate through emergency exits.
- You can also evacuate from the main entrance. (Please **do not use an elevator.**)
- An emergency assembly point is a car park of this facility.
- Please follow an instruction of local staffs.

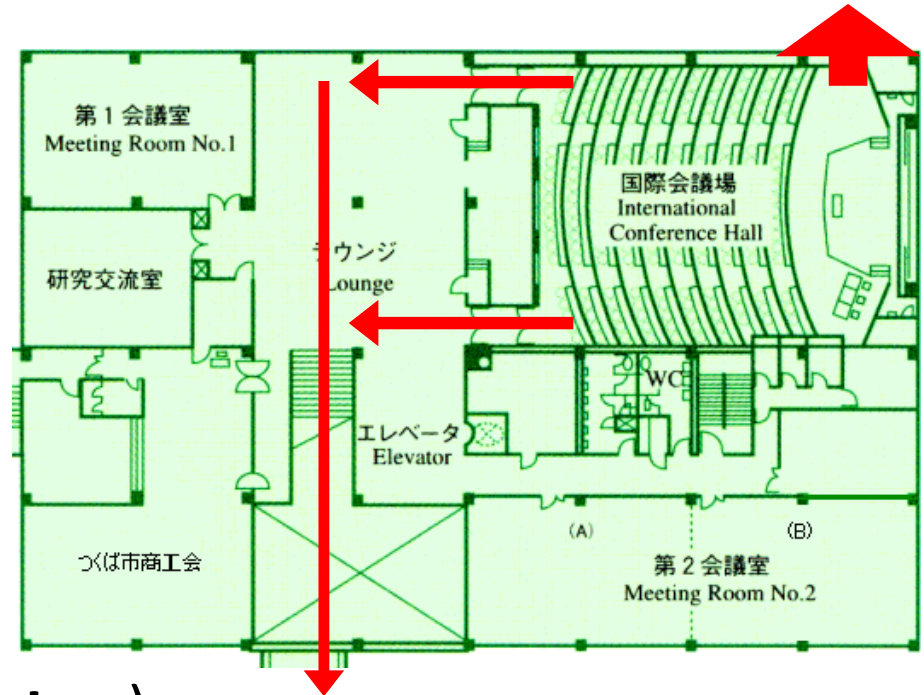

Food / Smoking

- No food or drink is allowed in the conference hall except for plastic bottles of water.



- This facility is **smoke-free**.

- There is a smoking area outside.

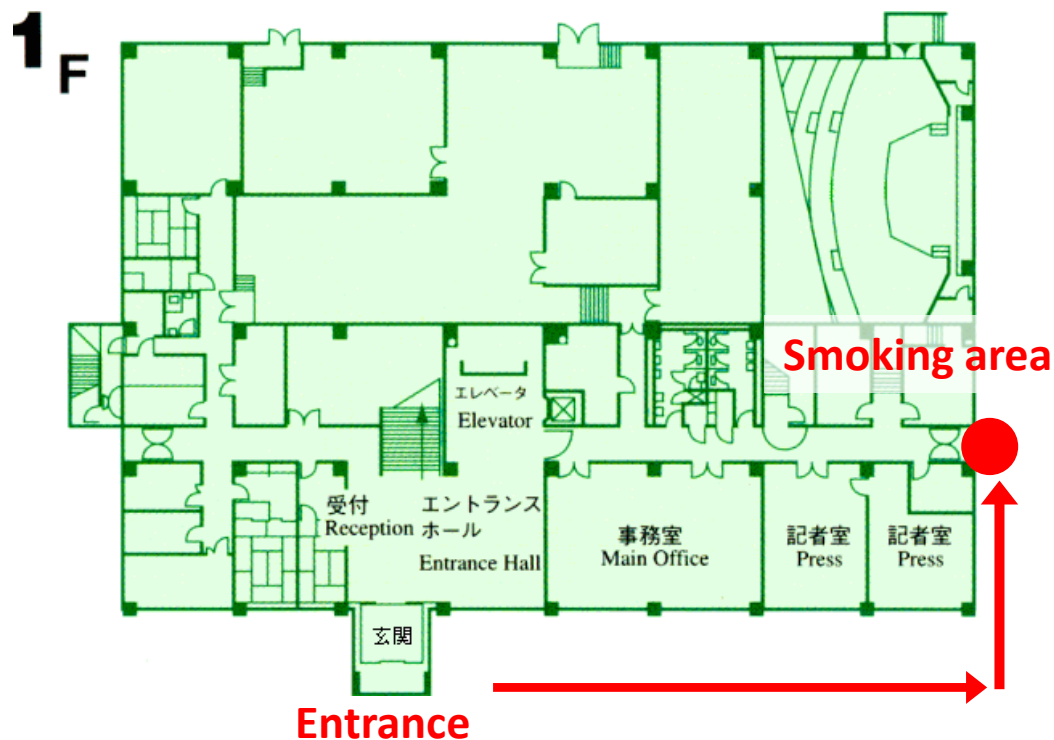

Health information (COVID-19)

- Please **wear a mask** in indoor space. (Spare masks are available at the registration desk.)
- If you have any symptoms of COVID-19, please let local staffs know ASAP.
 - Please measure your temperature using a non-contact thermometer at the entrance.
 - Please sanitize your hands. (Hand sanitizer is available at the registration desk and entrance).
 - COVID-19 antigen test kits are available upon request.



Wireless Internet

SSID:

IBARAKI-FREE-Wi-Fi

Password:

ibarakiken

Electric outlet

Some seats have electric outlets below a desk.



Lunch

- Mekiki no Ginji (seafood)



Sashimi rice bowl

- Yagura (Sushi)
***close at 14:00**



Nigiri Sushi

- Kagari (Japanese)
***close at 14:00**



Tendon (Tempura rice bowl)



Sushi gozen

Lunch

- Aoba (Ramen noodle)



Chukasoba (ramen)

- Kandy spice (curry)



Chicken thigh curry

- Aoi (Ramen noodle)

* crowded during 12:00-13:00



- Monster (Asian)



Pho



Gaprao (Thai Stir Fry Chicken with Basil)

Lunch

Tsukuba station



Map data ©2022 100 m

Please let local staffs know your choice, they will take you to a restaurant.

Oral session

- Please set your name in zoom as:
First-Name Family-Name (Affiliation)
(e.g., Yosuke Fujii (JMA-MRI))
- Please turn your microphone and video camera off anytime other than when you make a presentation, a question/comment.
- Please use the chat or “raised hand” in zoom to ask your question.
- A presentation slot is 18 minutes (15 min. for presentation plus 3 min. for Q&A)
- Bells ring at 12, 15, and 18 minutes.
- Please upload your presentation to the Slack before your presentation.
- All the presentations will be recorded and shared on the Slack.



Press a button when you speak.

Poster session (14:00-14:50, 15th Nov.)

- A list of poster presentations is available on the slack channel (#0_poster-session).
- Physical posters will be put on 15th and 16th (morning).
- You may ask your question online, please write your question in a thread of each poster.
- 2-min. flash poster talks (12:20-12:40) will be recorded, and they will be uploaded to the slack.

Workshop purpose

Joint Workshop of the OS-Eval TT and CP-TT and SynObs Kick-Off

Objectives:

- To emphasize the importance of ocean observing co-design/evaluation and data assimilation development for more effective use of ocean observation data.
- To promote developments for increasing oceanic impacts in earth system predictions.
- To share the objectives/goals of SynObs and to set up SynObs activities.

Program at a glance (JST)

SynObsKOWS Overall Configuration

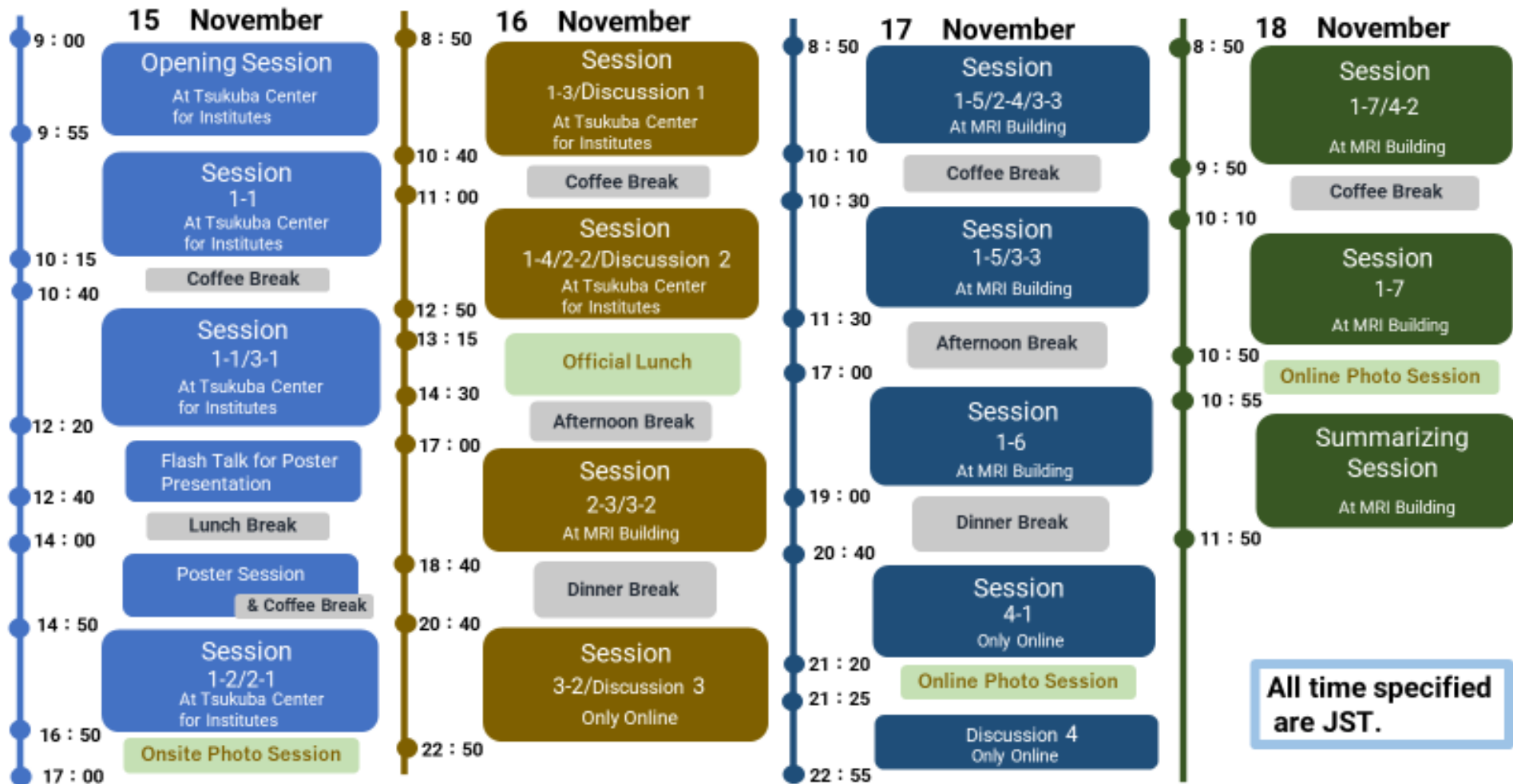

つくばへようこそ！

Welcome to Tsukuba, Japan!